

Procedure 7.16 - Replacing A Toothed Pulley

Removing the Toothed Pulley

If you are removing only one toothed pulley assembly, remove only one cover. It is not necessary to remove both covers unless you are removing both toothed pulleys.

1. Remove the cover necessary to access the toothed pulley you are removing as described in Procedure 7.1.

WARNING

Before continuing with this procedure, review the Warning and Caution statements listed in Section One, Things You Should Know.

2. Press down the stair arm with one hand. With your other hand, grasp and pull the end of the stairarm belt connected to the return spring. Release the stair arm. Remove the belt from the toothed pulley and belt idler (refer back to Diagram 7.10).
3. Remove the retaining ring from the toothed pulley (see Diagram 7.15).
4. Remove the five thrust washers, toothed pulley, and wave washer from the sheave shaft.
5. If you are replacing only one toothed pulley...

THEN...

Continue with the next step.

OTHERWISE...

Repeat Steps 2 through 4 for the second pulley; then continue with the next step.

Replacing the Toothed Pulley

6. Visually inspect the thrust washers and the wave washer removed in Step 4 for wear or damage. If the visual inspection indicates no wear or damage...

THEN...

Use the original washers when you perform the following steps.

OTHERWISE...

Replace the worn or damaged washers with new washers when you perform the following steps.

7. Slide a thrust washer, the wave washer, and three more thrust washers onto the sheave shaft.

Important

There is text on one side of the toothed pulley. When you replace the right pulley, position the pulley on the sheave shaft so that the text faces you when you stand on the right side of the climber. When you install the left toothed pulley, position the pulley on the sheave shaft so that the text faces away from you when you stand on the left side of the climber.

8. Slide the toothed pulley onto the sheave shaft. If the pulley is on the right side of the climber, face the pulley and rotate it counterclockwise while you watch the sheave. If the pulley is on the left side of the climber, face the pulley and rotate it clockwise while you watch the sheave.
9. If the sheave moves...

THEN...

The pulley is correctly installed;
continue with the next step.

OTHERWISE...

Remove the pulley and re-position it on
the sheave shaft.

10. Slide the remaining thrust washer onto the sheave shaft. Install the retaining ring next to the pulley.

Diagram 7.15 - Toothed Pulley Mounting

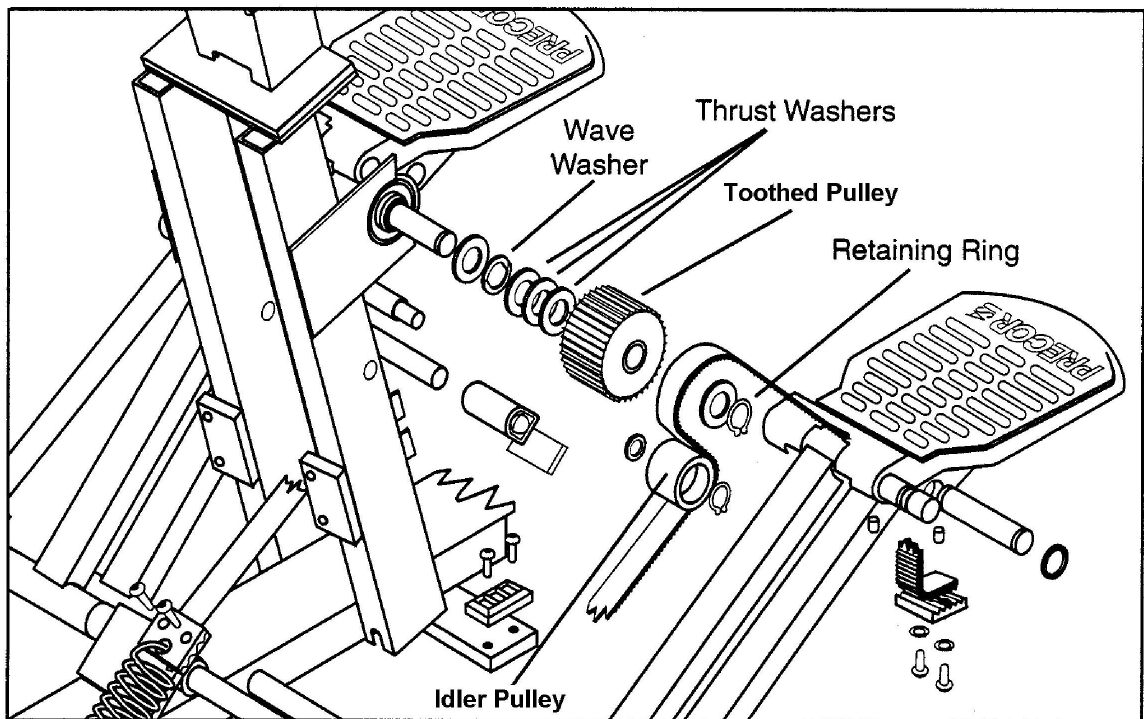

11. Lift the stairarm assembly from the frame weldment. Grasp the stairarm belt and lift it over the toothed pulley. Route the belt under the idler pulley.
12. If you are replacing only one toothed pulley...

THEN...

Continue with the next step.

OTHERWISE...

Repeat Steps 6 through 10 for the second pulley; then continue with the next step.

13. Check the operation of the climber as described in Section Four, then replace the cover as described in Procedure 7.1.